



New Council Offices

Newark and Sherwood District Council



Engaging with the community

Hoarding from the site gate to the corner

NEWARK AND SHERWOOD DISTRICT COUNCIL - INVESTING IN THE COMMUNITY

NEW PUBLIC SECTOR HUB

Efficient, low energy buildings

Multiple public sector services

Multi-million pound investment

Jobs and apprenticeships created

This has given me the opportunity to build a career in construction

www.newark-sherwooddc.gov.uk
Find us at Great North Road, Newark NG24 1BL

Hoarding one the corner pieces up to the main run on alongside the road
(In front of the town council sign to come down)

NEWARK AND SHERWOOD DISTRICT COUNCIL - INVESTING IN THE COMMUNITY

NATIONAL CIVIL WAR TRAIL

Download our Trail App, search for NCWT

TAKE A JOURNEY AROUND SOME OF THE MOST SIGNIFICANT HISTORICAL LOCATIONS USING THE LATEST TECHNOLOGY

www.nationalcivilwarcentre.com

Discover REAL history

Engaging with the community

The main run of hoarding along the roadside



(Each section magnified)

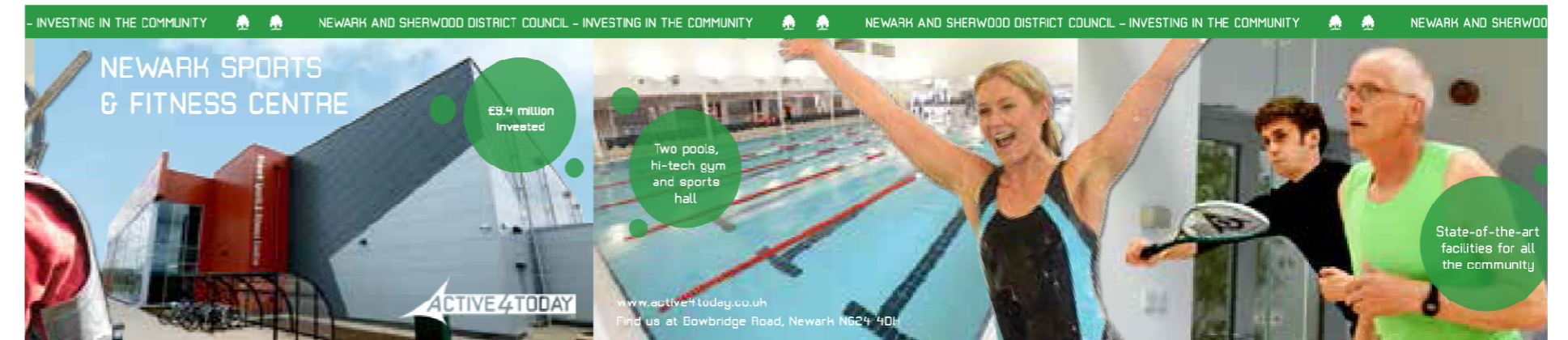



Incil Yard

EI Sub Sta

Andreas

New Offices

63 Public Parking

Coach / minibus drop off Point

Possible location of new pumping station (tbc).

33 Public Parking

Car/taxi only drop off Point

Service yard/vans

New security fence and gate to secure cycle area and vehicle access gates.

Cycle Racks (30 cycles) - covered cycle shelters for staff use.

Secure fence and gate for cycle storage and no through route for pedestrians.

Less-abled Mobility Scooter storage / lockup (2 scooters)

5 no. Sheffield cycle hoops for public use.

Car Park

MP 17

FF&E

Shower room
3 x shower curtains
1 x hairdryer
1 x bench
1 x drying cupboard
11 x two door lockers

Meeting Rooms
2 x 8 person tables
2 x 6 person tables
28 meeting chairs

Task Chairs - swivel chairs (as floors above)
19 x Customer service/booths/interview/office
21 x DWP
8 x Self service (customer)
Total: 48

Customer Chairs
20 x customer service booths
38 x DWP
8 x interview rooms
Total: 66

Waiting Chairs (modular, joined)
28 x customer services
2 x visitors
9 x DWP
Total: 41

Customer Service
1 x 5 shelf cupboard

DWP
2 x admin desks
3 x 3 shelf cupboards
1 x 4 drawer filing cabinet
1 x 5 shelf cupboard

PPE Room
5 x two door lockers

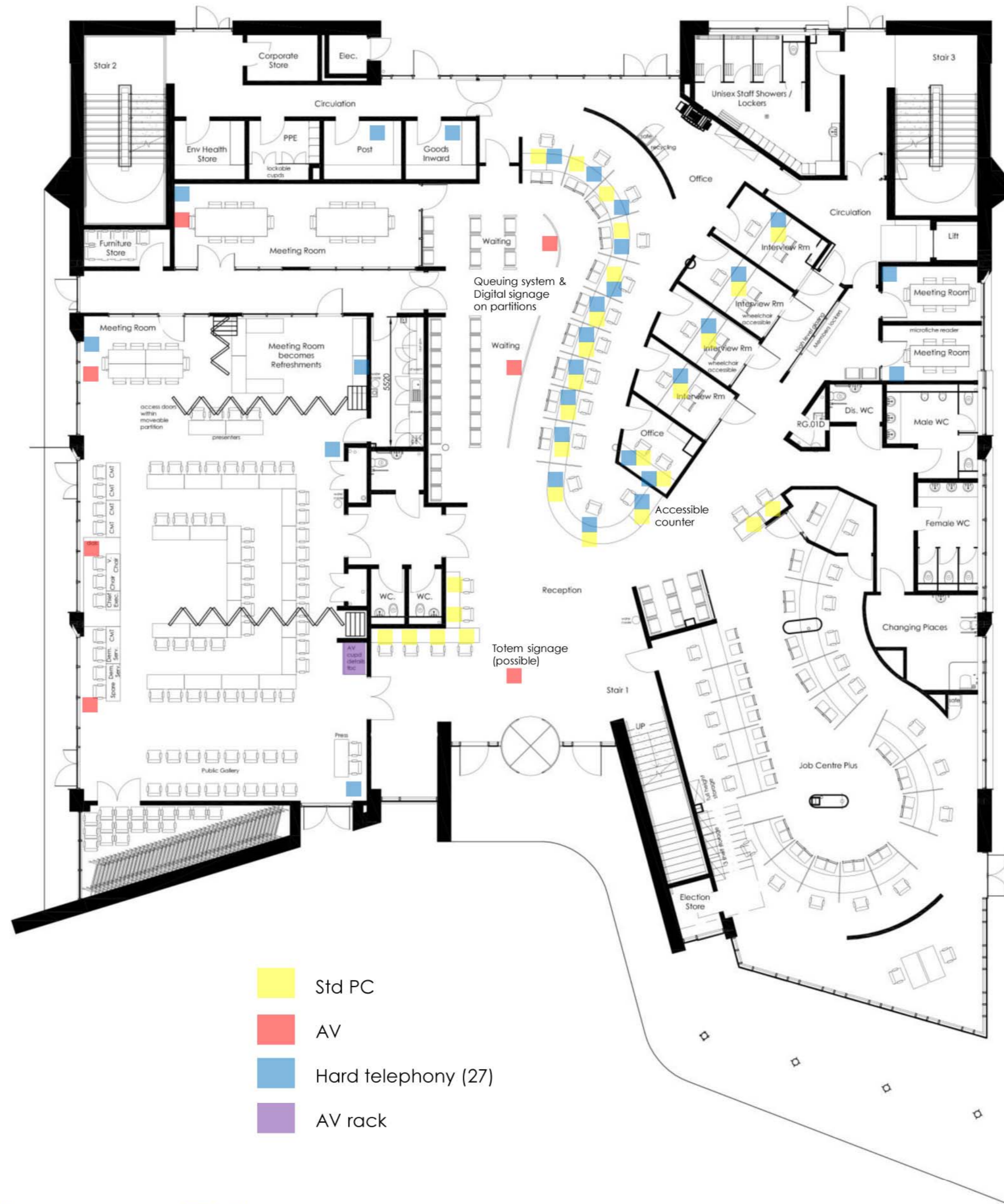

FF&E

40 x members lockers in visitor
Waiting area

Full Council Layout
29 x tables (one small)
72 x chairs
Raised dais - portable

Conference Layout
50 x tables
100 x chairs

Civic Suite Flexible Meeting Rooms
8 x meeting tables
20 x chairs

Civic store approx. capacity
46 x tables
72 x chairs (stacks of 4)

Furniture store approx. capacity
36 chairs

IT/AV equipment
Self serve: 8 x monitor stands

Kitchen
Water cooler
1 x larder fridge
2 x waste bins
1 x dishwasher

Items to take from KH
2 x safes
MFD/Printer
Post room pigeon holes

Ground Floor Plan

FF&E

Tall storage (5 shelves) 28lm = 140lm
 Mid storage (4 shelves) 16lm = 64lm
 Desk end (3 shelves) 35lm = 105lm

Pods

1x meeting pod
 1x tables
 4 x chairs

Open meet 1

Soft seating
 2 x low tables

Open Meet 2

2 x round tables
 7 x round stools

Open Meet 3

High table
 7 x chairs

Open meet 4

High back perimeter seating
 2 x round stools
 1 x square table

Stand & Meet

2lm mid storage (4 shelves)
 1sqm stand and meet table

Kitchen & Hub

7 x round tables
 28 x chairs
 4 x booth seating with tables
 8 x stools
 5200lm benching to match kitchen worktop
 2 x larder fridges
 2 x microwaves
 1 x dishwasher
 1 x water cooler – bottle type

Touchdown

4 x 1700 mm benches
 8 x Touchdown high chairs

4 x recycling points

Small Meeting 1

Soft seating 6lm – 6 sections
 Coffee table

Small Meeting 2

Round table
 6 x chairs

Meeting Room

4 x meeting tables
 8 x chairs
 Credenza

Repro

Storage 2lm

Members Meeting Room

2 x sofas
 Coffee tables
 Round meeting table
 4 x meeting chairs
 Credenza

Chairman's Meeting Room

2 x sofas
 Coffee tables
 Round meeting table
 4 x meeting chairs
 Credenza



DESKS 1F TO 122F (headcount)

NEIGHBOURHOOD 1

10 desks, 21 headcount
 (21) Customer Services – 10 desks
 Small square desk (KH)

NEIGHBOURHOOD 2

44 desks, 74 headcount
 (34) Revenue & Benefits – 24 desks
 (25) DWP – 5 desks
 (10) CAB – 11 desks
 (5) CVS – 4 desks

NEIGHBOURHOOD 3

16 desks, headcount 55
 (34) Sports Development – 1 desk
 (11) Community Safety – 8 desks
 (6) Policy & Commissioning – 4 desks
 (3) Performance – 2 desks
 (1) Parks & Amenities – 1 desk

NEIGHBOURHOOD 4

44 desks, headcount 49
 (15) HSG O&E – 11 desks
 (2) Information Governance – 1 desk
 (1) Procurement – 1 desk
 (7) Asset Management – 5 desks
 (14) IT 10 desks
 (4) Communications – 3 desks
 (6) Finance – 13 desks

8 unassigned desks

45F, 46F, 63F, 64F, 65F,
 68F, 71F, 121F

Headcount of all teams = 212
 Including 22 DWP at ground floor = 234
 Desks assigned 114
 Desks unassigned 8
 Total: 122 desks and chairs
 57 x 1400lm desk screens

Cloaks & lockers: 22 linear metres
 Lockers:
 Lockers assigned 234
 Lockers unassigned 6
 240 lockers supplied (60 rows of 4)

First Floor Plan

FF&E

Tall storage (5 shelves) 26lm = 130lm
 Mid storage (4 shelves) 13lm = 52lm
 Desk end (3 shelves) 37lm = 111lm

Pods

3 x meeting pod
 3x tables
 12 x chairs

Small Meeting 1
 Soft seating 6lm – 6 sections
 Coffee table

Open meet 1

Soft seating
 2 x low tables

Small Meeting 2
 Round table
 6 x chairs

Open Meet 2

2 x round tables
 7 x round stools

Meeting Room
 8 x tables
 8 x chairs
 2 x credenzas

Open meet 4

High back perimeter seating
 2 x round stools
 1 x square table

Planning Layout & Plotter

1sqm stand and meet table
 300 x 1000mm table (KH)
 Plotter (KH)

Kitchen & Hub

8 x round tables
 32 x chairs
 4 x booth seating with tables
 8 x stools
 5200lm benching to match kitchen worktop
 2 x larder fridges
 2 x microwaves
 1 x dishwasher
 1 x water cooler – bottle type

Touchdown

3 x 1700 mm benches
 6 x Touchdown high chairs

Repro

Storage 2lm 4 shelf
 4 x recycling points

Training Room
 12 x meeting tables
 24 x chairs
 Credenza

- Visual management
- AV
- Hard telephony
- TV aerial
- Smart board



DESKS 123S TO 233S (headcount)

NEIGHBOURHOOD 5

49 desks, 62 headcount
 (6) CMT – 4 desks
 (9) HR – 7 desks
 (4) Legal – 3 desks
 (21) Admin – 20 desks
 (22) Environmental Health – 15 desks

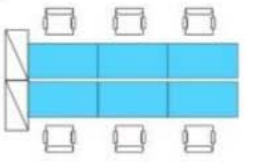

NEIGHBOURHOOD 6

34 desks, 48 headcount
 (2) Building Control – 1 desk
 (4) Strategic Housing – 3 desks
 (4) Ec. Development – 3 desks
 (9) Planning Admin – 6 desks
 (17) Planning – 12 desks
 (6) Planning Policy – 4 desks
 (6) Democratic Services – 5 desks

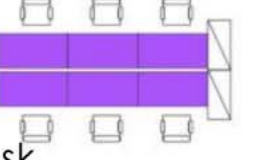

NEIGHBOURHOOD 7

(37)NSH – 26 desks
 Assumes 7/10

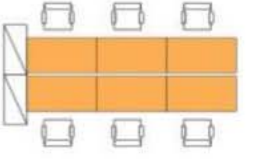

2 Unassigned desks
 147S, 150S

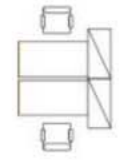

Headcount of all teams = 147
 Desks assigned 109
 Desks unassigned 2
 Training room 16
 Total: 127 desks and chairs
 54 x 1400lm desk screens

Cloaks & lockers: 22 linear metres
 Lockers:
 Lockers assigned 147
 Lockers unassigned 5
 Total: 147 lockers for headcount
 152 lockers supplied (38 rows of 4)

Second Floor Plan